

32 Acres  
Bertram, Tx



32 acres on the south fork of the San Gabriel River located on CR 330 about 5 minutes west of Bertram and 10 minutes east of Burnet. The front of the property is highlighted by a hill overlooking a year-round pond. From there, the land slopes towards the river valley featuring a coastal Bermuda field and pecan trees. No HOA and no deed restrictions. Ag-exempt. Within an hour to downtown Austin.

**\$832,000**



This information is deemed reliable but is not guaranteed. c.c.



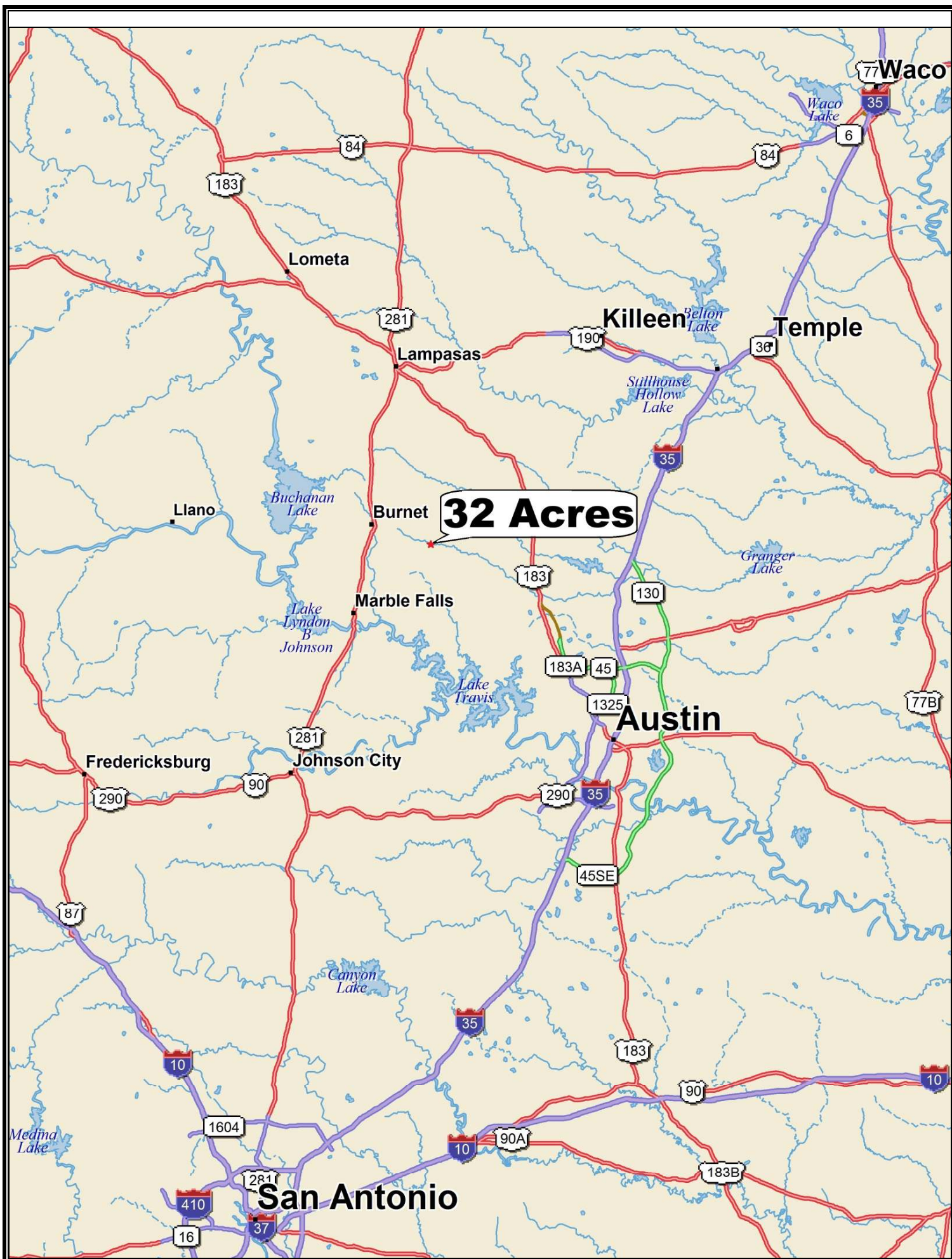



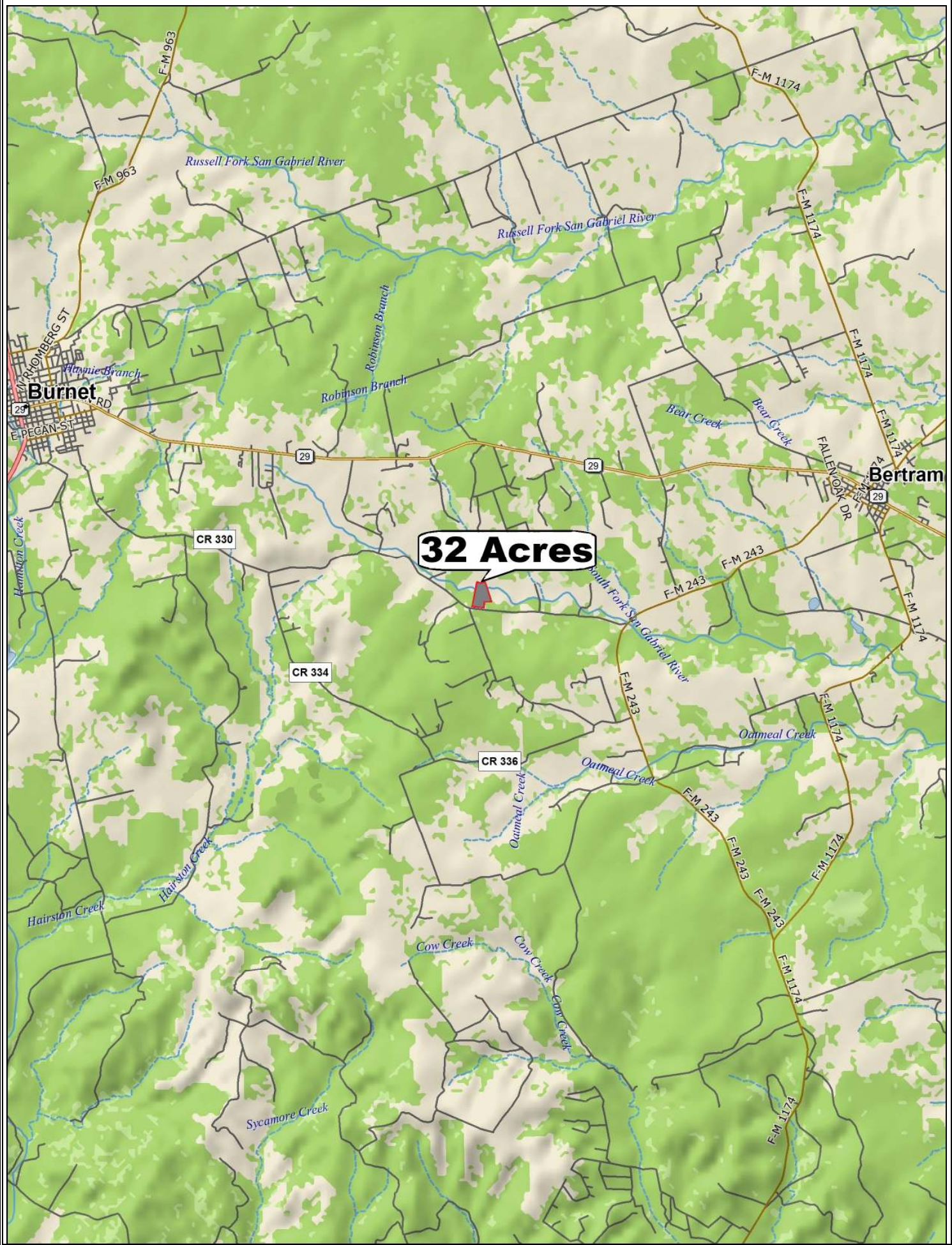







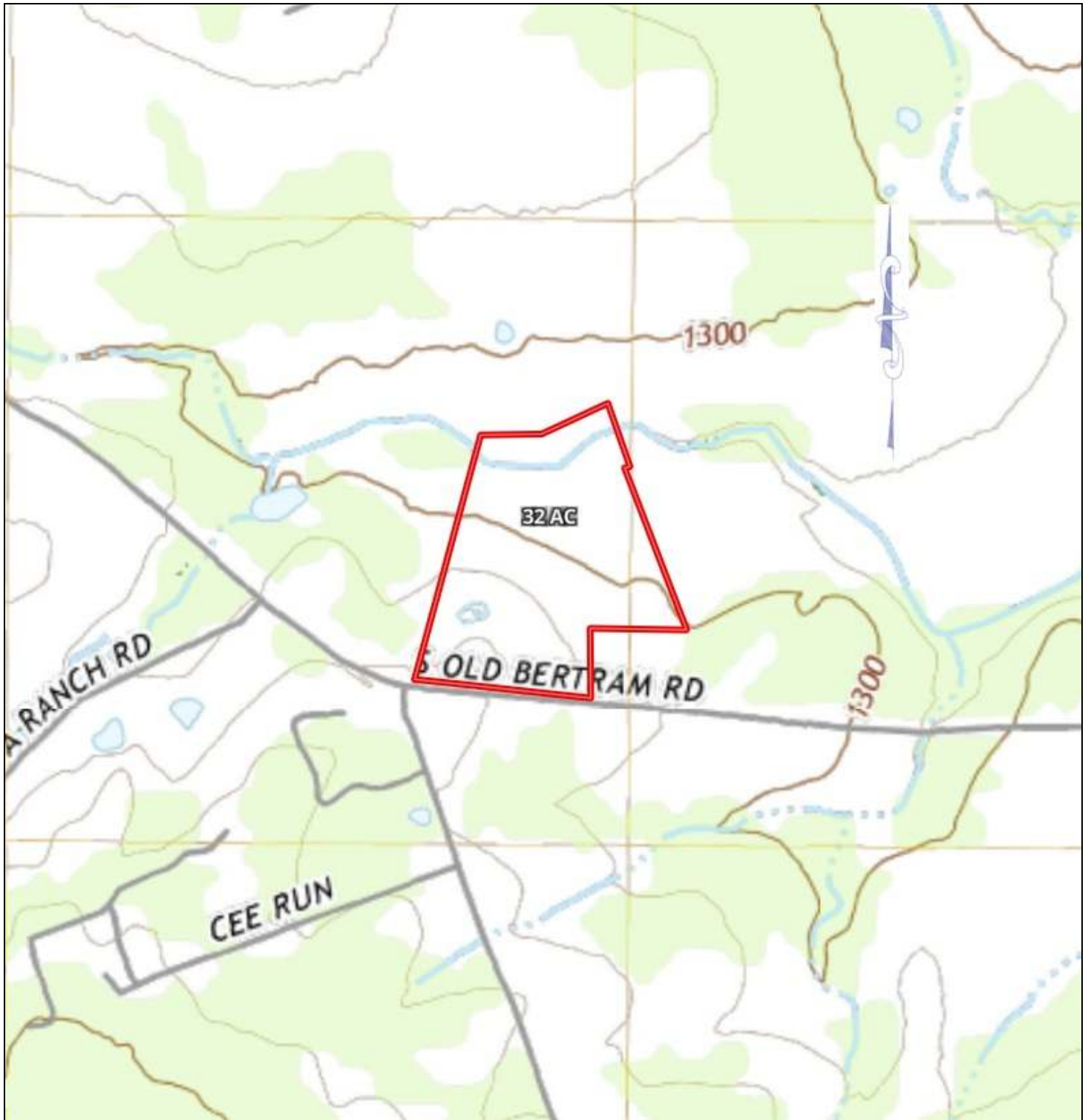





## Property Summary Sheet

**LOCATION:** County Road 330, Bertram, Tx

**SIZE:** 32+/- acres

**FENCING:** Partial

**SURFACE WATER:** San Gabriel River, pond

**SCHOOL DISTRICT:** Burnet

**TAX RATE:** 1.33, Agricultural exemption

**RESTRICTIONS:** None

All sizes, areas, volumes, lengths and distances contained herein are only approximations and are not intended, nor should they be accepted as exact measurements. All information furnished is from sources deemed reliable, but no warranty or representation, expressed or implied, is made to the accuracy thereof, and is submitted to prior sale, withdrawal or other changes in the price or terms without notice.



email: [ranches@jimberryranchsales.com](mailto:ranches@jimberryranchsales.com)